

Nadelventil PN 100

Messing

- Gewindeanschluß (Muffe)
 beiderseits: Whitworth-Rohrgewinde DIN ISO 228

Needle Valve PN 100

brass

- threaded connection (bush)
 both sides: Whitworth pipe thread DIN ISO 228

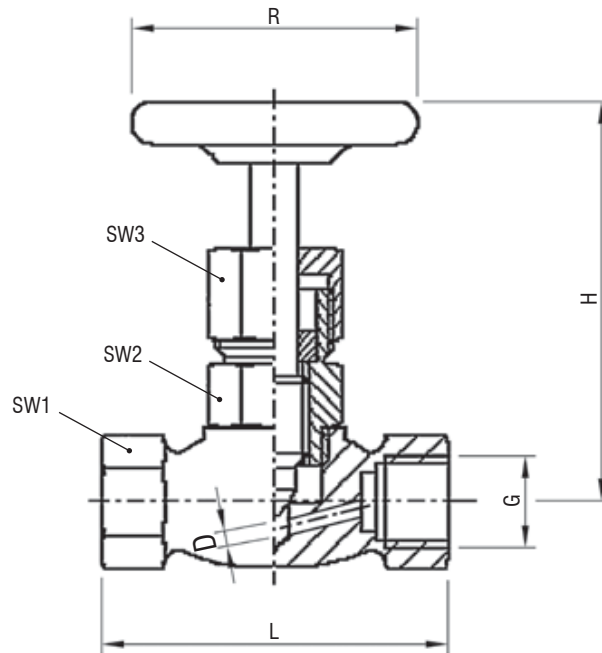

| AW-Nr. AW no. | Pos. item | Bezeichnung denomination | Werkstoff material | nach DIN EN acc. to DIN EN | Werkstoff-Nr. material no. |
|------------------|--------------|------------------------------|--|-------------------------------|-------------------------------|
| 214 | 1 | Gehäuse / body | Messing / brass | CuZn39Pb3 | CW614N |
| | 2 | Oberteil / bonnet | Messing / brass | CuZn39Pb3 | CW614N |
| | 3 | Spindel / stem | Messing / brass | CuZn39Pb3 | CW614N |
| | 4 | Dichtung / seal | G 1/8" - 1/2": Perbunan G 3/4" - 2": PTFE | | |
| | 5 | Stopfbuchsmutter / gland nut | Messing / brass | CuZn39Pb3 | CW614N |
| | 6 | Handrad / hand wheel | Pressstoff / pressed material | | |

| G | L | H | D | R | SW ₁ | SW ₂ | SW ₃ | ≈ kg |
|--------|-----|-----|-----|----|-----------------|-----------------|-----------------|-------|
| 1/8" | 50 | 78 | 4 | 50 | 22 | 19 | 19 | 0,270 |
| 1/4" | 50 | 78 | 5 | 50 | 22 | 19 | 19 | 0,275 |
| 3/8" | 50 | 78 | 6 | 50 | 22 | 19 | 19 | 0,275 |
| 1/2" | 55 | 78 | 6,5 | 63 | 25 | 19 | 19 | 0,330 |
| 3/4" | 67 | 90 | 9 | 63 | 32 | 22 | 22 | 0,540 |
| 1" | 75 | 90 | 11 | 63 | 40 | 22 | 22 | 0,750 |
| 1 1/4" | 110 | 110 | 13 | 90 | 54 | 24 | 27 | 1,850 |
| 1 1/2" | 110 | 110 | 15 | 90 | 58 | 24 | 27 | 1,850 |
| 2" | 110 | 110 | 15 | 90 | 70 | 27 | | |

Maße und Gewichte können je nach Hersteller abweichen / depending on manufacturers measures and weight can change